

## LED-Außenwand und Straßenleuchte (Fotозellen verfügbar)

(Das XX steht für die Farbtemperatur.)

**Model No.:** ST04-XX01 ST05-XX01

**Leistung:** 35W 50W

### 1. Eigenschaften

- Universalspannung AC100-277V 50 / 60Hz.
- 130 lm / W für die Befestigung.  
mit hochwertigen SMD3030 Chips.
- Treiber mit Konstantstromversorgung.
- Druckausgleich zwischen Atmosphäre und Gehäuse, zur Vermeidung von Kondensbeslag
- 5 Jahre Garantie.
- Erhältlich mit Lichtschrankensensor.
- CE, RoHs, UL-Zertifikat.

Hoher Leistungsfaktor > 0,9, niedriger THD-Treiber.

Aus Aluminiumdruckguss mit PC-Abdeckung und Schutzklasse IP65.



### 2. Zeichnung

Einheit: mm

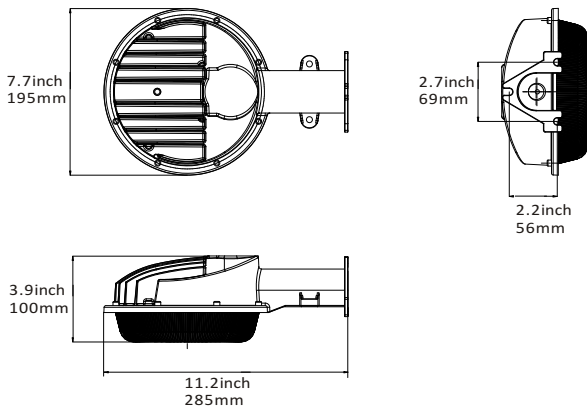

#### Photocell sensor (optional)

Photo electric switch for outdoor use  
Lighting from early evening & Dark when dawn

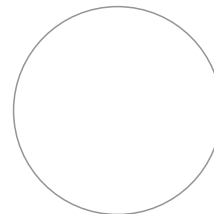

Fotozellensensor A.

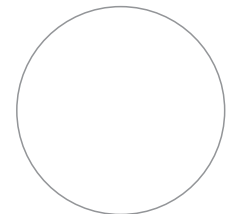

Fotozellensensor B.

### 3. Application

Widely used in Shopping mall, hotel, shop, showroom, cafe, restaurant, garden, porch, etc.



LM80



ErP



IP65



## 4. Parameters

The "XX" represents Color temperature.

| Artikel             | Modell             | ST04-XX01                  | ST05-XX01                  |
|---------------------|--------------------|----------------------------|----------------------------|
| Allgemeine Leistung | Leistung           | 35W                        | 50W                        |
|                     | Lumen              | 4550lm                     | 6500lm                     |
|                     | Effektiv           | 130lm/W                    | 130lm/W                    |
|                     | Farbtemperatur     | 3000K/4000K/5000K/5700K    | 3000K/4000K/5000K/5700K    |
|                     | LED Typ            | SMD 3030                   | SMD 3030                   |
|                     | CRI                | Ra>70                      | Ra>70                      |
| Elektrisch          | Power Factor       | >0.9                       | >0.9                       |
|                     | Eingangsspannung   | 100-277VAC,50/60Hz         | 100-277VAC,50/60Hz         |
|                     | THD                | <20%                       | <20%                       |
|                     | Lichtwinkel        | 120°                       | 120°                       |
| Physikalisch        | Gewicht            | 1.35Kg                     | 1.4Kg                      |
|                     | Dimension          | 285x195x100mm              | 285x195x100mm              |
|                     | Gehäuse            | Aluminium-Druckguss        | Aluminium-Druckguss        |
|                     | Diffuser           | PC                         | PC                         |
|                     | Montage            | Wandmontage, Straßenmasten | Wandmontage, Straßenmasten |
|                     | Betriebstemperatur | -35°C~55°C                 | -35°C~55°C                 |
|                     | Finish             | Brown                      | Braun                      |
|                     | IP Grad            | IP65                       | IP65                       |
| Zertifikate         | Zertifikat         | CE, RoHS                   | CE, RoHS                   |
|                     | Treiber Klasse     | Klasse II                  | Klasse II                  |
|                     | Lebensdauer        | 50.000 Stunden             | 50.000 Stunden             |

## 5. Chip Temperature Test

Hervorragende Wärmeableitungsleistung, gut für die LED-Lebensdauer

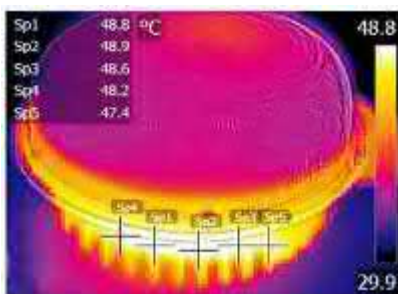

LM80



ErP



IP65



## 6. Verteilungskurve

### 35W LED

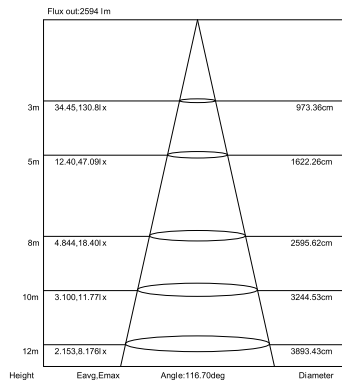
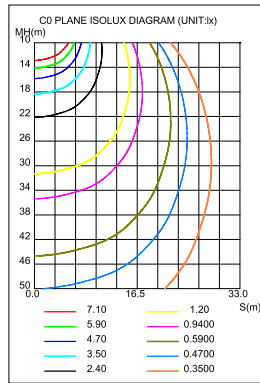
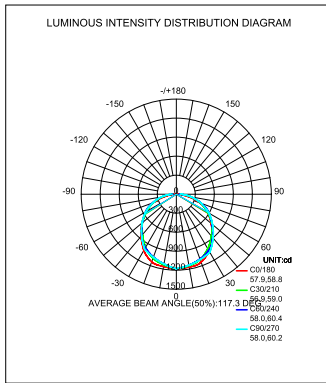

### 50W LED

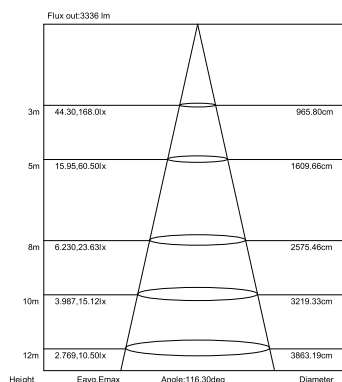
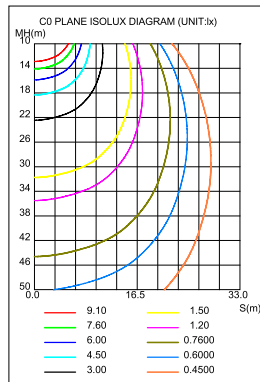
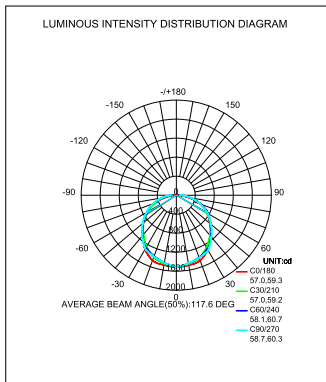

### Wall Mounting

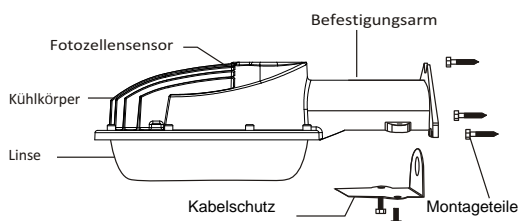

### Arm Mounting

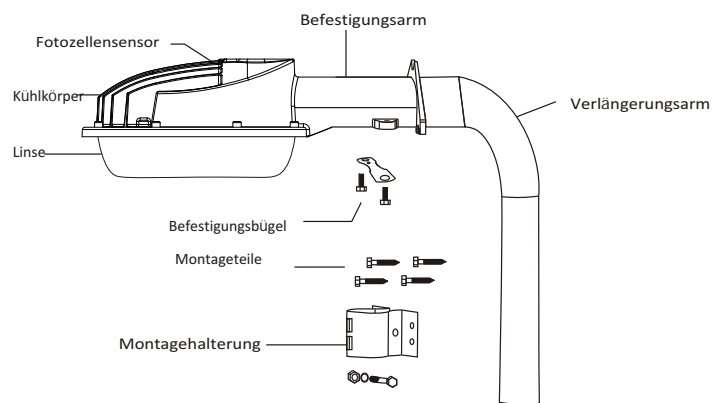

LM80



IP65



## 7. Verpackung

### Verpackung: Wandmontage

| Nr. | Modell    | Watt | N.G.   | Innere Verpackung | Stk./Ktn. | Gewicht | Maße Karton   |
|-----|-----------|------|--------|-------------------|-----------|---------|---------------|
| 1   | ST04-XX01 | 35W  | 1.35Kg | 300x200x110mm     | 6         | 9.0Kg   | 410x310x350mm |
| 2   | ST05-XX01 | 50W  | 1.40Kg | 300x200x110mm     | 6         | 9.3Kg   | 410x310x350mm |

### Verpackung: Armmontage

| Nr. | Modell    | Watt | N.G.             | Innere Verpackung | Stk./Ktn | Gewicht          | Maße Karton                     |
|-----|-----------|------|------------------|-------------------|----------|------------------|---------------------------------|
| 1   | ST04-XX01 | 35W  | 1.90Kg<br>4.18lb | ---               | 1        | 2.25Kg<br>4.95lb | 430x260x145mm<br>17"x10.2"x5.7" |
| 2   | ST05-XX01 | 50W  | 1.95Kg<br>4.29lb | ---               | 1        | 2.30Kg<br>5.06lb | 430x260x145mm<br>17"x10.2"x5.7" |

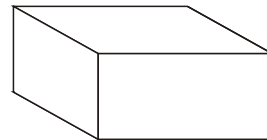
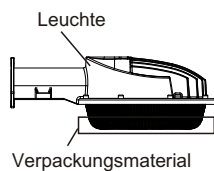

### Verpackung: Wandmontage

Menge: 6 STÜCKE

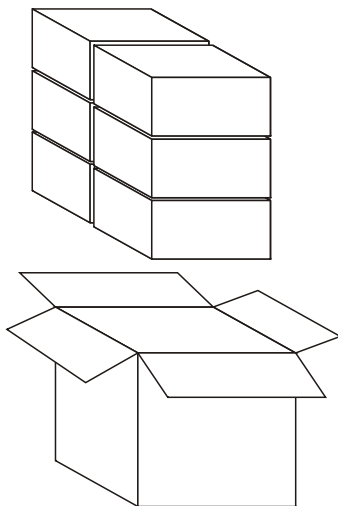

Innenbox 300x200x110mm (11,8"x7,9"x4,3 ")

Menge/Karton 6 Stück

Karton außen 410x310x350mm(16.1"x12.2"x13.8")

### Verpackung: Armmontage

Menge: 1 STÜCK

Verlängerungsarm (1  
STÜCK)

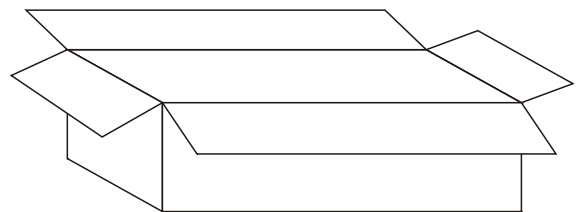
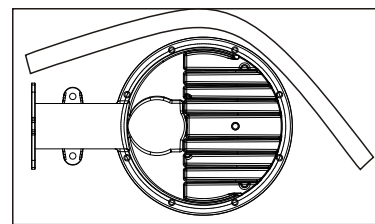

Menge / Karton 1 STÜCK

Außenkarton 425 x 250 x 130 mm (16,7 x 9,8 x 5,1 mm)



LM80

